

Hose reel OSM 500

EBINGER

Technisches Equipment



- Spring rewind mechanism
- Latching system
- Max. 25m hose - 1/2" hose
- Casing in painted steel or stainless steel
- Fixed mounting bracket
- Adjustable hose guide
- Mountable in any position

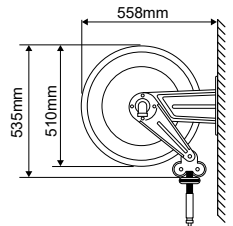
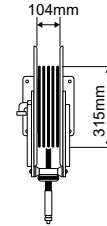
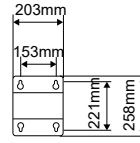

Painted steel



| Medium | Length of the hose | Inner Ø | Max. pressure | Max. temp. | Swivel | Swivel connection | Armature | Item-No. |
|-------------------|--------------------|---------|---------------|------------|-----------------|-------------------|----------------|-----------|
| Cold water | without | - | 20bar | 90°C | brass | 1/2" F | - | 1.500.100 |
| | 25m | 1/2" | 12bar | 50°C | brass | 1/2" F | brass coupling | 1.500.101 |
| | 20m | 5/8" | 10bar | 50°C | brass | 1/2" F | brass coupling | 1.500.102 |
| Hot water | without | - | 20bar | 90°C | brass | 1/2" F | - | 1.500.100 |
| | 20m | 1/2" | 15bar | 90°C | brass | 1/2" F | brass coupling | 1.500.104 |
| | 15m | 5/8" | 15bar | 90°C | brass | 1/2" F | brass coupling | 1.500.105 |
| Compressed air | without | - | 20bar | 90°C | brass | 1/2" F | - | 1.500.100 |
| | 25m | 12,5mm | 20bar | 50°C | brass | 1/2" F | NW 7,2 | 1.500.103 |
| Vacuum | 20m | 1/2" | 5bar | 50°C | brass | 1/2" F | - | 1.500.140 |
| High pressure 100 | without | - | 100bar | 130°C | stainless steel | 1/2" F | - | 1.500.200 |
| | 20m (black) | 13mm | 100bar | 130°C | stainless steel | 1/2" F | M22x1,5 F | 1.500.202 |
| High pressure 200 | without | - | 200bar | 130°C | stainless steel | 3/8" F | - | 1.500.300 |
| | 25m (black) | 8mm | 200bar | 130°C | stainless steel | 3/8" F | M22x1,5 F | 1.500.301 |
| | 25m (black) | 10mm | 200bar | 130°C | stainless steel | 3/8" F | M22x1,5 F | 1.500.302 |
| | 25m (blue) | 8mm | 200bar | 130°C | stainless steel | 3/8" F | M22x1,5 F | 1.500.303 |
| High pressure 400 | without | - | 400bar | 130°C | stainless steel | 3/8" F | - | 1.500.400 |
| | 25m (black) | 8mm | 400bar | 130°C | stainless steel | 3/8" F | M22x1,5 F | 1.500.401 |
| | 25m (black) | 10mm | 400bar | 130°C | stainless steel | 3/8" F | M22x1,5 F | 1.500.402 |
| | 25m (blue) | 8mm | 400bar | 130°C | stainless steel | 3/8" F | M22x1,5 F | 1.500.403 |
| Pesticides | without | - | 100bar | - | stainless steel | 1/2" F | - | 1.500.200 |
| | 25m | 3/8" | 40bar | - | stainless steel | 1/2" F | 1/2" F | 1.500.240 |
| | 20m | 1/2" | 40bar | - | stainless steel | 1/2" F | 1/2" F | 1.500.241 |
| Grease | without | - | 400bar | 60°C | steel zined | 3/8" F | - | 1.500.500 |
| | 25m | 3/8" | 400bar | 60°C | steel zined | 3/8" F | 3/8" M | 1.500.502 |
| Oil | without | - | 150bar | 60°C | steel zined | 1/2" F | - | 1.500.900 |
| | 25m | 1/2" | 150bar | 60°C | steel zined | 1/2" F | 1/2" M | 1.500.902 |

Hose reel OSM 500

EBINGER

Technisches Equipment

Painted steel



| Medium | Length of the hose | Inner Ø | Max. pressure | Max. temp. | Swivel | Swivel connection | Armature | Item-No. |
|--------------|--------------------|-----------|---------------|------------|--------|-------------------|-----------------|-----------|
| Oxygen - Gas | without | - | 20bar | - | brass | 3/8" F | - | 1.500.700 |
| | 20m | 2x8mm | 20bar | - | brass | 3/8" F | 3/8" F & 1/4" F | 1.500.701 |
| | 15m | 2x9mm | 20bar | - | brass | 3/8" F | 3/8" F & 1/4" F | 1.500.702 |
| Gas LPG | without 25m | - 10mm | 20bar | - | brass | 3/8" F | - | 1.500.800 |
| | | | 20bar | - | brass | 3/8" F | 3/8" F-L | 1.500.802 |

Stainless steel



| Medium | Length of the hose | Inner Ø | Max. pressure | Max. temp. | Swivel | Swivel connection | Armature | Item-No. |
|----------------------|--------------------|---------|---------------|------------|-----------------|-------------------|----------------|-----------|
| Cold water | without | - | 20bar | 90°C | brass | 1/2" F | - | 1.504.100 |
| | 25m | 1/2" | 12bar | 50°C | brass | 1/2" F | brass coupling | 1.504.101 |
| | 20m | 3/8" | 10bar | 50°C | brass | 1/2" F | brass coupling | 1.504.102 |
| Hot water | without | - | 20bar | 90°C | brass | 1/2" F | - | 1.504.100 |
| | 20m | 1/2" | 15bar | 90°C | brass | 1/2" F | brass coupling | 1.504.104 |
| | 20m | 5/8" | 15bar | 90°C | brass | 1/2" F | brass coupling | 1.504.105 |
| Compressed air | without 25m | - | 20bar | 90°C | brass | 1/2" F | - | 1.504.100 |
| | | | 20bar | 50°C | brass | 1/2" F | NW 7,2 | 1.504.103 |
| Vacuum | 20m | 1/2" | 5bar | 50°C | brass | 1/2" F | - | 1.504.140 |
| High pressure 100 | without | - | 100bar | 130°C | stainless steel | 1/2" F | - | 1.504.130 |
| | without | - | 100bar | 130°C | stainless steel | 1/2" F | - | 1.504.200 |
| | 20m (black) | 13mm | 100bar | 130°C | stainless steel | 1/2" F | M22x1,5 F | 1.504.202 |
| | 20m (blue) | 13mm | 100bar | 130°C | stainless steel | 1/2" F | M22x1,5 F | 1.504.205 |
| | without | - | 100bar | 130°C | stainless steel | 1/2" F | - | 1.504.230 |
| High pressure 200 | without | - | 200bar | 130°C | stainless steel | 3/8" F | - | 1.504.300 |
| | 25m (black) | 8mm | 200bar | 130°C | stainless steel | 3/8" F | M22x1,5 F | 1.504.301 |
| | 25m (black) | 10mm | 200bar | 130°C | stainless steel | 3/8" F | M22x1,5 F | 1.504.302 |
| | 25m (blue) | 8mm | 200bar | 130°C | stainless steel | 3/8" F | M22x1,5 F | 1.504.303 |
| | 25m (blue) | 10mm | 200bar | 130°C | stainless steel | 3/8" F | M22x1,5 F | 1.504.304 |
| High pressure 400 | without | - | 400bar | 130°C | stainless steel | 3/8" F | - | 1.504.400 |
| | 25m (black) | 8mm | 400bar | 130°C | stainless steel | 3/8" F | M22x1,5 F | 1.504.401 |
| | 25m (black) | 10mm | 400bar | 130°C | stainless steel | 3/8" F | M22x1,5 F | 1.504.402 |
| | 25m (blue) | 8mm | 400bar | 130°C | stainless steel | 3/8" F | M22x1,5 F | 1.504.403 |
| | 25m (blue) | 10mm | 400bar | 130°C | stainless steel | 3/8" F | M22x1,5 F | 1.504.404 |
| Pesticides | without | - | 100bar | - | stainless steel | 1/2" F | 1/2" F | 1.504.200 |
| | 25m | 3/8" | 40bar | - | stainless steel | 1/2" F | 1/2" F | 1.504.240 |
| | 20m | 1/2" | 40bar | - | stainless steel | 1/2" F | 1/2" F | 1.504.241 |
| Ad Blue | 25m | 1/2" | 20bar | 50°C | stainless steel | 1/2" F | Cap nut 1" | 1.504.220 |
| Respiratory air | 25m | 3/8" | 10bar | 50°C | stainless steel | 1/2" F | 3/8" M | 1.504.260 |
| Drinking water | 20m | 1/2" | 20bar | 50°C | stainless steel | 1/2" F | brass coupling | 1.504.273 |
| Food | 20m | 1/2" | 15bar | 100°C | stainless steel | 1/2" F | brass coupling | 1.504.204 |
| Grease | without 25m | - | 400bar | 60°C | steel zined | 3/8" F | - | 1.504.500 |
| | | | 400bar | 60°C | steel zined | 3/8" F | 3/8" M | 1.504.502 |
| Oil | without 25m | - | 150bar | 60°C | stainless steel | 1/2" F | - | 1.504.200 |
| | | | 150bar | 60°C | stainless steel | 1/2" F | 1/2" M | 1.504.902 |

Optional accessories

| Designation | Material | Item-No. |
|---|-----------------|------------------------|
| Cover plate for latching system | ABS | 1.510.005 |
| Extension for swiveling wall bracket 180° | stainless steel | 1.514.007 |
| Swivling wall bracket, 110° | painted steel | 1.510.001 |
| Swivling wall bracket, 110° | stainless steel | 1.514.001 |
| Turntable, only suitable for floor mounting | Steel zinced | 1.610.002 |
| Automatic hose guide for 1/2" - 5/8" hose for 3/4 - 1" hose | painted steel | 1.510.010 1.510.011 |
| Automatic hose guide for 1/2" - 5/8" hose for 3/4 - 1" hose | stainless steel | 1.514.010 1.514.011 |
| Hoseguide, 180° transshiptable | painted steel | 1.610.003 |
| „Speed control“ rewinding break | Techno-Polymer | 1.410.008 |
| Hose trolley with 4 breaking solid rubber wheels with 4 breaking air wheels | steel zinced | 130.001 130.002 |
| Hose trolley with 4 breaking solid rubber wheels with 4 breaking air wheels | stainless steel | 130.003 130.004 |



- !** Automatic hose guide not suitable for oxygen, gas and duo hoses!
 „Speed control“ rewinding break not combinable with automatic hose guide!
 Cover plate for latching system not combinable with automatic hose guide!
 Cover plate for latching system not combinable with hosguide, 180° transshiptable!

The changeover to RAL 7016 will take place successively

